

VILLAGE AT NEW LONGVIEW

GARDEN HOME COLLECTION

AURORA

STARTING IN THE MID \$400'S



1,479 SQ FT
2 STORY



2 CAR GARAGE



2 BEDROOMS



2.5 BATHS



BASEMENT



UNFINISHED
18'-6" x 41'-8"

FEATURES

- 768 SQFT MAIN FLOOR
- 711 SQFT 2ND FLOOR
- FULL UNFINISHED BASEMENT
- 2-CAR GARAGE W/COVERED WALK
- FENCED PET-FRIENDLY YARD
- 9' & 10' CEILINGS
- QUEEN ANNE VICTORIAN DESIGN
- 'PRACTICAL LUXURY' UPGRADED FINISHES

MAIN FLOOR

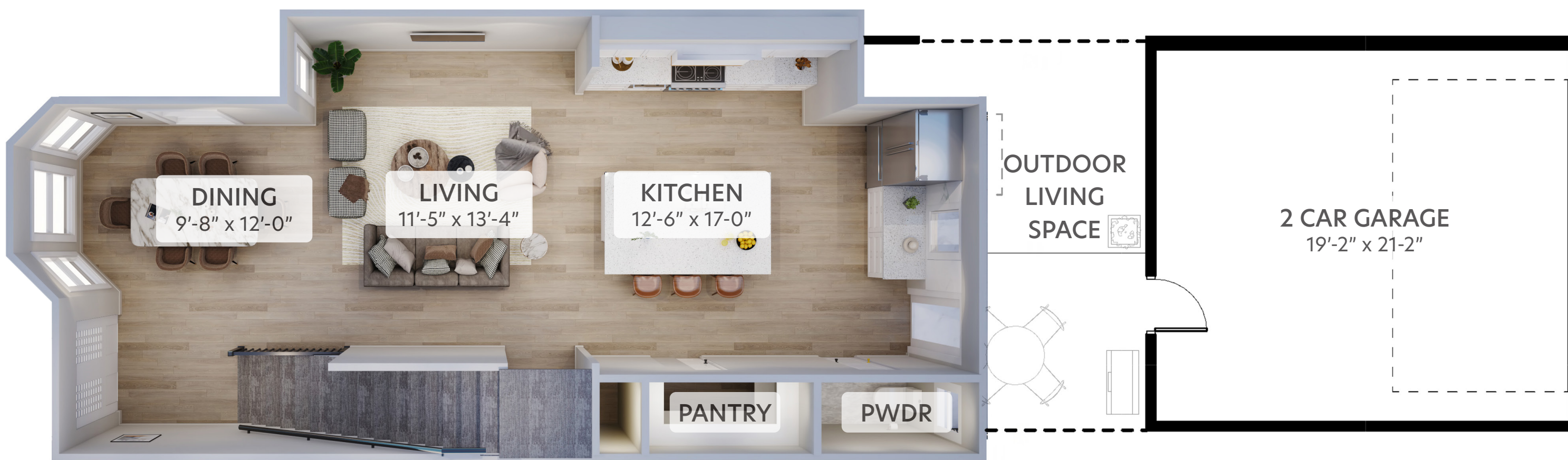

DINING
9'-8" x 12'-0"

LIVING
11'-5" x 13'-4"

KITCHEN
12'-6" x 17'-0"

OUTDOOR
LIVING
SPACE

2 CAR GARAGE
19'-2" x 21'-2"

PANTRY

PWDR

UPPER FLOOR

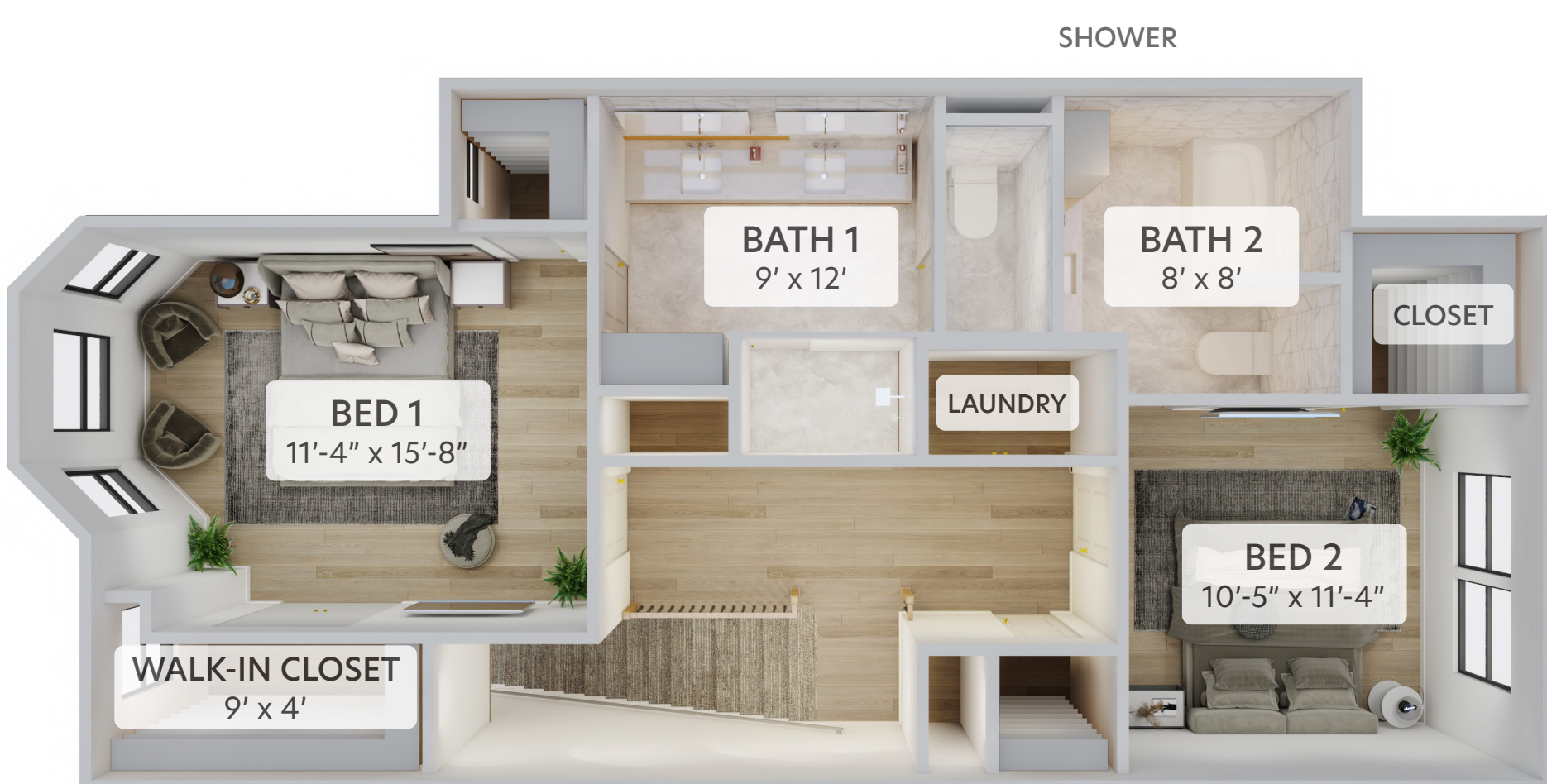

SHOWER

BATH 1
9' x 12'

BATH 2
8' x 8'

CLOSET

BED 1
11'-4" x 15'-8"

LAUNDRY

BED 2
10'-5" x 11'-4"

WALK-IN CLOSET
9' x 4'



BRYAN PARRISH
(816) 309-1767



kw PARTNERSSM
KELLERWILLIAMS.

KELLER WILLIAMS REALTY PARTNERS INC
Each office is independently owned and operated



VILLAGE

AT NEW LONGVIEW